

SMT-500CL

Laser Tachometer with Contact Adaptor

Features

- Accurate non-contact and contact measuring
- Selectable measuring units for length, rotational- and surface speed measurement
- Rugged aluminium dye cast housing
- Securely fixed screw-in adaptor to convert from non-contact to contact operation
- High value instrument for professional use in industrial environments



Details

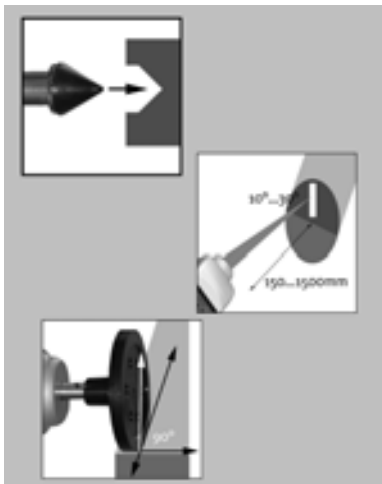

Series SMT-500 tachometers are robust precision instruments designed for frequent use for measuring revolution, surface speed and distance (length). The large LC-Display or the bright red LE-Display allows an excellent readability also at places with adverse illumination.

The models SMT-500CL and SMT-510CL measure RPM by means of a highly visible red laser beam. A reflective tag fixed to the revolving machine part can be detected by the instrument from a distance to 4m. By attaching a contact adaptor and a measuring tip / wheel the instrument can sense RPM, surface speed or length in selectable international measuring units.

Due to the state of the art measuring technology and very precise laser measuring combined with additional possibilities of direct measuring method, the instrument offers utmost versatility for servicing, calibrating and monitoring for various machines and plants.

Order Info

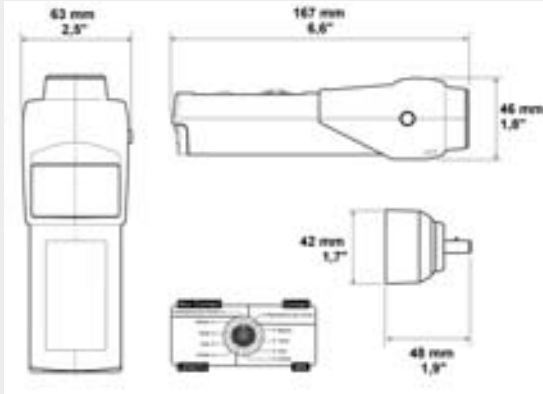

SMT-500CL

SMT-510CL

Standard

Instrument with **LCD-Display**, contact adaptor, reflective tags, measuring tip, - cone, and - wheel, extension shaft, operation manual, 2 AA Batteries, carrying case

Instrument with **LED-Display**, contact adaptor, reflective tags, measuring tip, - cone, and - wheel, extension shaft, operation manual, 2 AA Batteries, carrying case

Option

SMT-500CLX LCD Instrument with 12" measuring wheel
SMT-510CLX LED Instrument with 12" measuring wheel

SMT-800 Calibration protocol (for new instrument)

Spec

SMT-500CL SMT-500CLX SMT-510CL SMT-510CLX

		SMT-500CL	SMT-500CLX	SMT-510CL	SMT-510CLX
Measuring Range	contact measurement	6...25.000 RPM			
	non contact	6...99.999 RPM			
	measuring distance	100...1.500 mm			
Measuring Principle		photo optical detection of a reflected laser beam			
Operation Mode	revolution	RPM contact RPM non contact			
	speed	m/min yd/min ft/min in/min			
	distance / length	m cm yd ft in			
Accuracy	revolution	0,006% (+/-1RPM) +/-0,06 RPM (<1000RPM) +/-0,6 RPM (<10000RPM)			
	speed / distance	0,4% (+/- 1Digit)			
Resolution	revolution	8 pulses/revolution (with contact adaptor)			
	distance	0,01905 m/pulses	0,0381 m/pulses	0,01905 m/pulses	0,0381 m/pulses
	displayed	without decimal point			
Display	type	LCD, 5-digit, 12mm high		red LED, 5-digit, 10mm high	
	update time	1000 msec		500 msec	
Memory	min / max / last	✓			
	additional values	10 recordable value			
Batteries	number / type	2 x 1,5V AA-type			
	live time	35 h		30 h	
	low battery indication	✓			
Ambient Temperature		0...45° C			
Weight		370 g			
Dimensions	LxWxH	203 x 63 x 46 mm			
Housing Material		aluminium-dye cast with tripod fixing 1/4-20unc, length 8mm			