

SMT-200CL

Digital Laser Tachometer with Contact Adaptor

Features

- Accurate contact or non-contact measurements with laser beam or measuring attachments
- Selectable measuring units for length and surface speed measurements in metre, yard, feet or inch
- Handy and ergonomical housing design
- Automatic and manual memory storage
- Excellent price-/performance ratio



Details

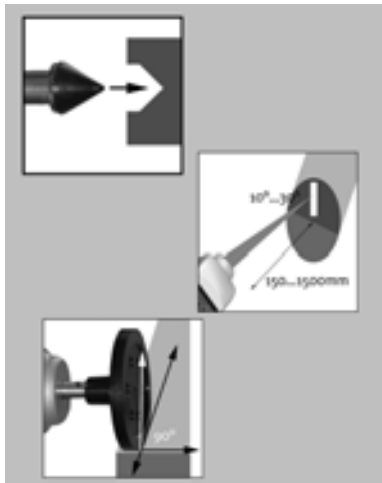

Series SMT-200 tachometers are small, handy and ergonomically well designed precision instruments to measure revolution, surface speed and distance (length).

Model SMT-200L measures RPM by means of a highly visible red laser beam. A reflective tag fixed to the revolving machine part can be detected by the instrument from a distance of up to 2 m. By attaching a contact adaptor and a measuring tip /-wheel the instrument can sense RPM, surface speed or length in selectable international measuring units.

Due to the state-of-the-art measuring technology and very precise laser measuring combined with additional possibilities of direct measuring method, the instrument offers utmost versatility for servicing, calibrating and monitoring for various machines and plants.

Order Info

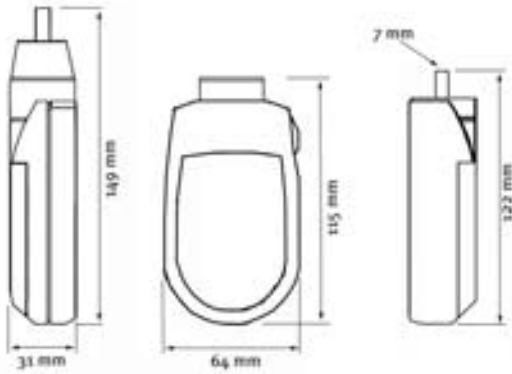

SMT-200C

SMT-200CL

SMT-200L

Standard

Instrument, measuring tip, - cone and - wheel, operation manual, batteries, carrying case.

Instrument, reflective tags, contact adaptor, measuring tip, - cone and - wheel, operation manual, batteries, carrying case.

Instrument, reflective tags, operation manual, batteries, carrying case.

Option

SMT-903 Measuring cone, metal with rubber insert
SMT-902 Measuring tip, metal with rubber insert
SMT-904 Measuring wheel, 6" with rubber surface
SMT-916 Reflective tags (4 sheets, 35 tags each)
SMT-800 Calibration protocol

Spec

SMT-200C

SMT-200CL

SMT-200L

		SMT-200C	SMT-200CL	SMT-200L
Measuring Range	contact measurement	1...25.000 RPM	6...25.000 RPM	
	non-contact		6...99.999 RPM	
	measuring distance		50...800 mm	
Measuring Principle		photo optical detection of a reflected laser beam		
Operation Mode	revolution	RPM contact	RPM contact non-contact	RPM non-contact
	speed	m/min yd/min ft/min in/min		
	distance / length	m yd ft		
	totalise / count	number of revolution		
Accuracy	revolution	0,006% (+/-1RPM)		
	speed / distance	0,4% (+/- 1Digit)		
Resolution	revolution	20 pulses / revolution	1 pulse / revolution	
	distance	0,00762 m/puls	0,02362m/pulse	
Display	type	LCD, 5-digit, 12mm high		
	update time	1000 msec		
Memory	min / max / last	✓		
	additional values	10 recordable values		
Batteries	number / type	3 x 1,5V AA-Type		
	live time	50 h		35 h
	low battery indication	✓		
Temperature Range	operation	0...45° C		
Weight		190 g	200 g	165 g
Dimensions	LxWxH	122 x 64 x 31 mm	149 x 64 x 31 mm	115 x 64 x 31 mm
Housing material		Polyamid, reinforced		